

HIGH SPEED SPINDLES

Air-cooled spindles

S 16 / S 18



Air-cooled spindle designed for high speed, precision and reliability. It is intended for building into machines or automated cells for such operations as grinding, drilling, milling and deburring etc. Compressed air-cooling (type P) is advisable when operating in either dirty or hostile environments or if more effective cooling is requested. The noise level will also be lower.



▲ S 16 - 60



▲ S 18 - 60

Technical specifications

S 16 / S 18

Housing:

Steel

Cooling:

Built-in fan
Compressed air (type P)

Ball bearings:

Permanently lubricated, spring pre-loaded,
high performance angular contact ball
bearings.

Electrical connection:

6-pin contact with PTC via frequency converter.

Rotation direction:

Right rotating
Left rotating (option)

HIGH SPEED SPINDLES

Air-cooled spindles

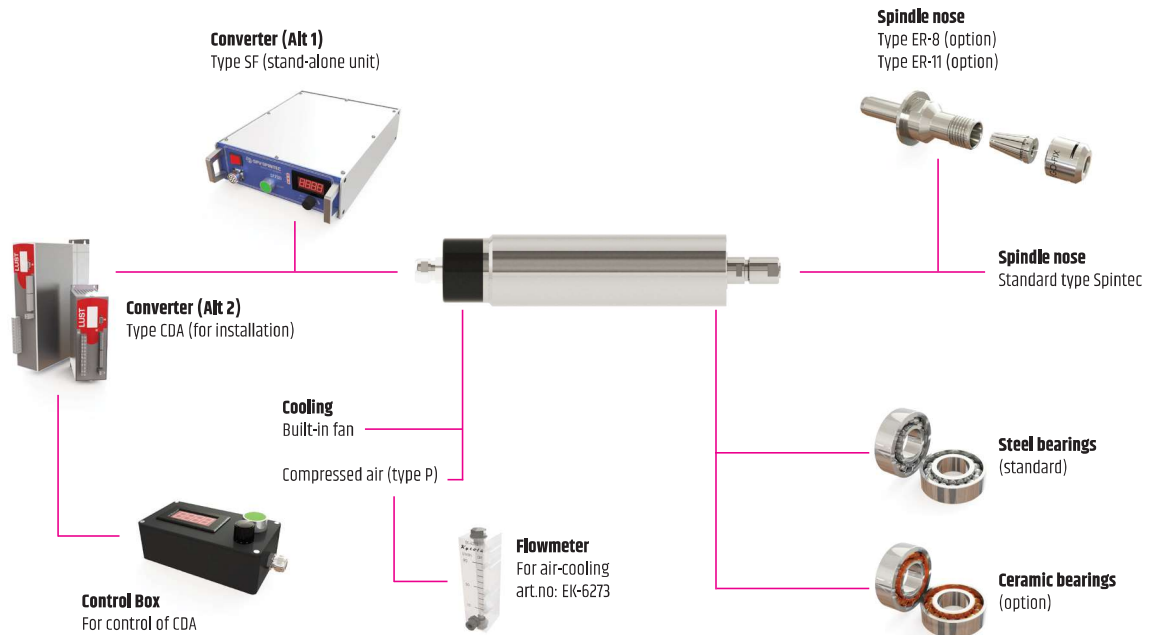

Standard accessories included

- ▲ 3 m cable
- ▲ 2 chuck keys
- ▲ 1 collet in any dimension (specify on order)

Drive unit

- ▲ Frequency converter, stand-alone unit: SF700
- ▲ Frequency converter for installation: CDA-0.75
- ▲ Control Box for control of CDA: CONTROL BOX

Spindle model	ØD1 mm	L1 mm	L2 mm	L3 mm	L4 mm	Weight kg	Spindle nose type	Collet max Ø mm
S 16 - 60	50	251 **	37	20	102	2,0	Spintec 17	8,0
S 18 - 60	45	251 **	37	20	102	2,0	Spintec 17	8,0
	Effect max kW	Voltage V	Speed max RPM	Speed min RPM	Run-out max mm	Coaxiality max mm	Air consumption l / min (type p)	Noise level dB
S 16 - 60	0,4	210	60 000	15 000	0,005	0,05	90 *	80
S 18 - 60	0,4	210	60 000	15 000	0,005	0,05	90 *	80

* The air flow between the spindle and the flowmeter may vary depending on various conditions
 ** Type P = +10 mm

