

## VM 10



Air-cooled motor intended for handwork and as spindle in machines where simpler drilling, grinding, milling and deburring is to be performed. Stainless steel housing (type R) is suitable for building into machines. Compressed air-cooling (type P) is advisable when operating in either dirty or hostile environments or if more effective cooling is required. The noise level will also be lower.



▲ VM 10  
Fan-cooled



▲ VM 10  
Compressed  
air-cooled

### Technical specifications

VM 10
<b>Housing:</b>
Anodized aluminum Stainless steel (type R)
<b>Cooling:</b>
Built-in fan Compressed air (type P)
<b>Ball bearings:</b>
Permanently lubricated, pre-loaded, high performance groove ball bearings.
<b>Electrical connection:</b>
6-pin contact via frequency converter.
<b>Rotation direction:</b>
Right rotating Left rotating (option)

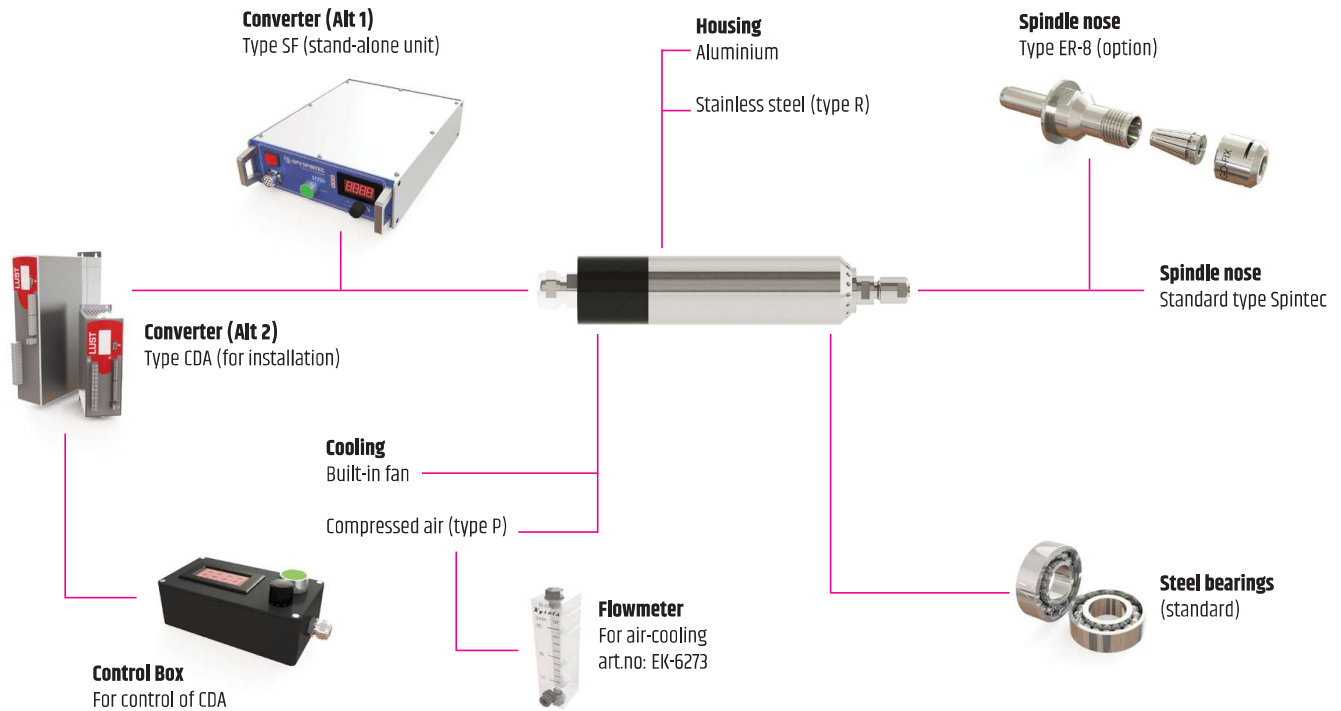

## Standard accessories included

- ▲ 3 m cable
- ▲ 2 chuck keys
- ▲ 1 collet in any dimension (specify on order)

## Drive unit

- ▲ Frequency converter, stand-alone unit: SF700
- ▲ Frequency converter for installation: CDA-0,75
- ▲ Control Box for control of CDA: CONTROL BOX

Spindle model	ØD1 mm	L1 mm	L2 mm	L3 mm	L4 mm	Weight kg	Spindle nose type	Collet max Ø mm
VM 10	33	177	26	15	71	0,3	Spintec 10	4,0
	Effect max kW	Voltage V	Speed max RPM	Speed min RPM	Run-out max mm	Coaxiality max mm	Air consumption l / min (type p)	Noise level dB
VM 10	0,1	184	72 000	36 000	0,01	0,3	50 *	74

\* The air flow between the spindle and the flowmeter may vary depending on various conditions

